

26701 - 26707 AGOURA ROAD
CALABASAS, CA 91362

R&D/WAREHOUSE
FOR SUBLEASE

26701

MICHAEL TINGUS
President
818.223.4380
mtingus@lee-re.com
www.miketingus.com
DRE# 01013724

GRANT FULKERSON, SIOR
Principal
818.304.4956
gfulkerson@lee-re.com
www.fulkerson-re.com
DRE# 01483890

 **LEE &
ASSOCIATES**

COMMERCIAL REAL ESTATE SERVICES
No warranty or representation is made to the accuracy of the foregoing information. Terms of sale or lease and availability are subject to change or withdrawal without notice. CID #01191898

26701 - 26707 AGOURA ROAD

CALABASAS, CA 91362



PROPERTY SPECIFICATIONS

Property Size:	93,286 SF
	26701 Agoura Rd (Building A) 22,116 SF
	26707 Agoura Rd (Building B) 71,170 SF
Loading:	(3) Ground Level
Clearance Height:	+/- 16 Feet
Power:	2,000 AMP / 277 480 VOLT
Parking:	3.45/1,000
Lease Rate:	Negotiable

PROPERTY HIGHLIGHTS

- Freeway Identity
- Heavy Power
- Elevator Served
- Walking Distance to Retail Amenities
- Abundant Parking
- Flexible Lease Term



26701 - 26707 AGOURA ROAD

CALABASAS, CA 91362



26701 - 26707 AGOURA ROAD

CALABASAS, CA 91362



AERIAL MAP



Lost Hills Rd

26701-26707 AGOURA RD

CALABASAS, CA

US
101

VENTURA FWY (US-101)

Agoura Rd

FLOOR PLANS

1ST FLOOR

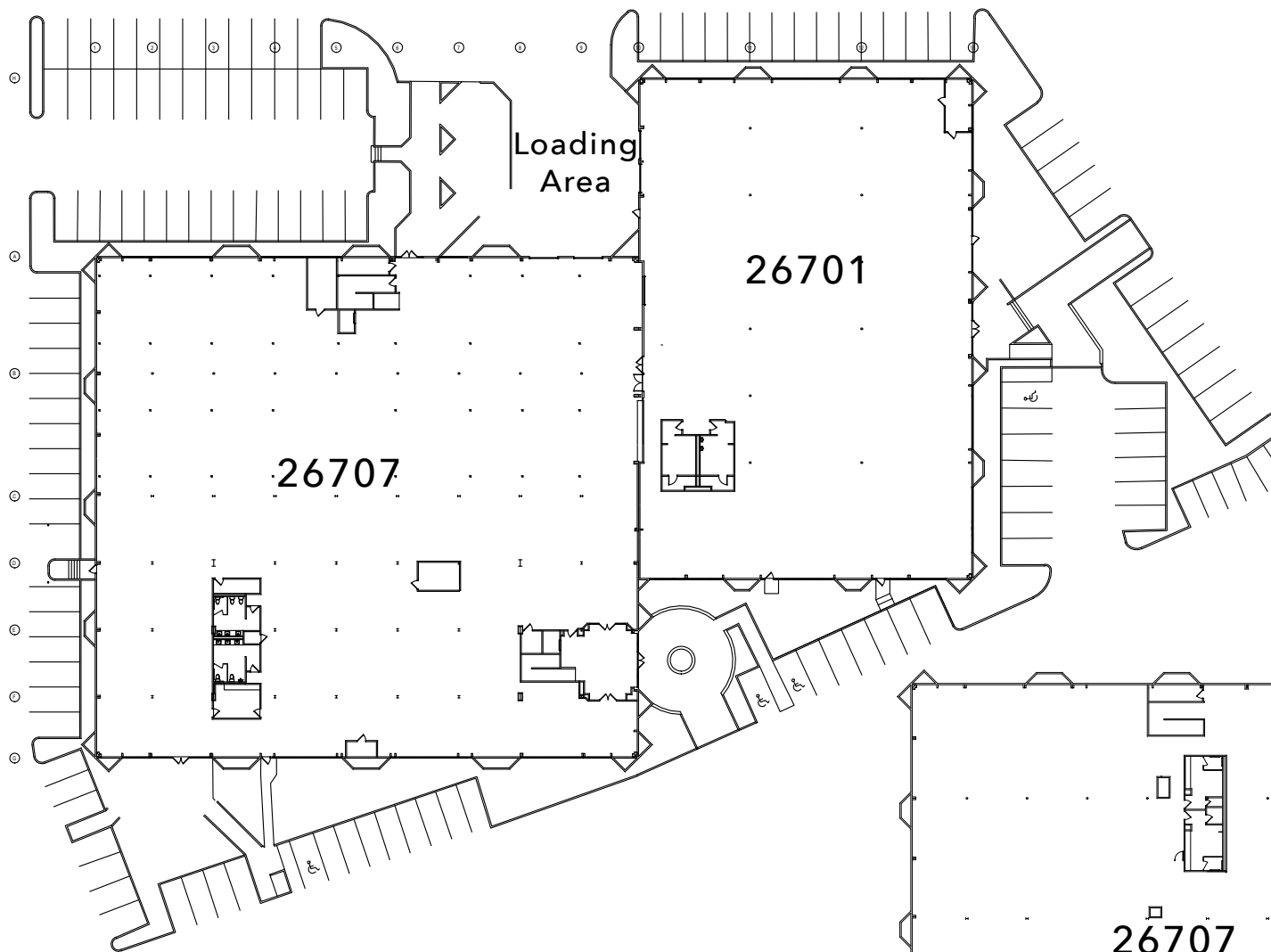

2ND FLOOR

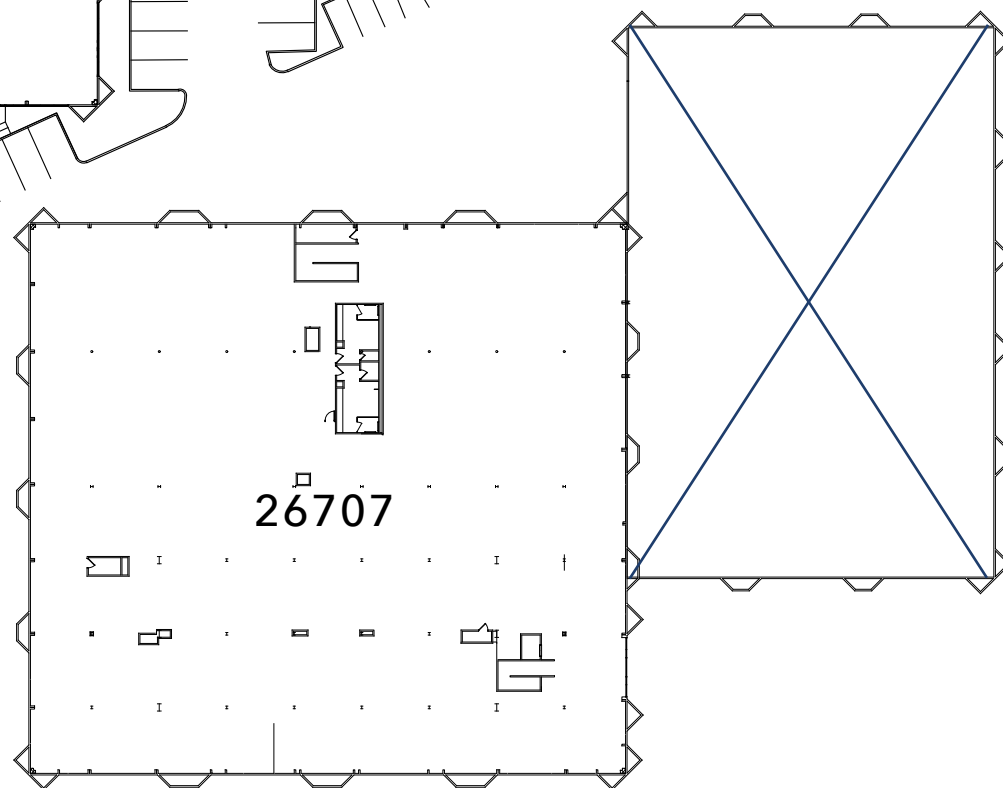

AMENITIES MAP

SUBJECT
26701-26707 Agoura Rd
Calabasas, CA

erewhon Natural Foods Market
universal appliance and kitchen center
Jersey Mike's SUBS
BCBC NAIL SPA
Furr Saj RESTAURANT
CosmoProf
HOME consignment
SUSHI NISHI calabasas
MyDaySpa and Wellness
Exer
SUNPOWER

Albertsons
Starbucks COFFEE
Jack in the box
McDonald's
TACO BELL
Pharmacy
Mobil
XpressLube
SHARKY'S WOODFIRE MEXICAN GRILL
Mediterranean PITA GRILL
Abbyson LIVING
7 ELEVEN
Shell
Chevron
UPS The UPS Store
Hanami RESTAURANT
Fantastic Sams HAIR SALON
CAMBRIA hotels



26701 - 26707 AGOURA ROAD
CALABASAS, CA 91362

R&D/WAREHOUSE
FOR SUBLEASE



COMMERCIAL REAL ESTATE SERVICES
Lee & Associates® - LA North/Ventura, Inc. Corporate ID #01191898
A Member of the Lee & Associates Group of Companies
5707 Corsa Avenue, Suite 200, Westlake Village, CA 91362
P: 818-223-4388 F: 818-591-1450 www.lee-associates.com

No warranty or representation is made to the accuracy of the foregoing information. Terms of sale or lease and availability are subject to change or withdrawal without notice. CID #01191898

MICHAEL TINGUS
President
818.223.4380
mtingus@lee-re.com
www.miketingus.com
DRE# 01013724

GRANT FULKERSON, SIOR
Principal
818.304.4956
gfulkerson@lee-re.com
www.fulkerson-re.com
DRE# 01483890